

# Know Your Results Will Be Accurate at All Levels, Whatever the Sample Type

Agilent 7900 ICP-MS

## Sample Introduction

The standard low-flow, Peltier-cooled sample introduction system (main picture) provides stable, consistent operation and supports matrix tolerant, robust plasma conditions. The optional Advanced Valve System (AVS), right, adds a piston pump and close-coupled 7-port switching valve for high-speed discrete sampling.

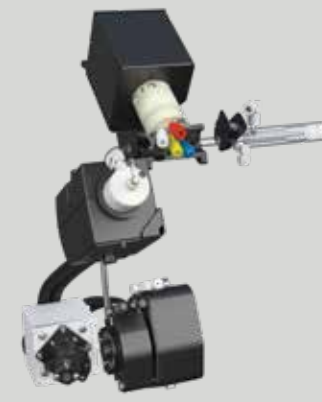

## Ultra High Matrix Introduction (UHMI)

Increases matrix tolerance up to 25% total dissolved solids (TDS). UHMI further improves plasma robustness, practically eliminating matrix suppression.

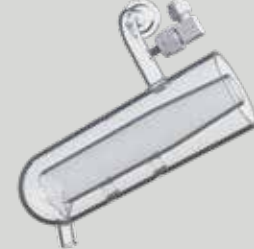

## Plasma and Shield Torch System (STS)

Provides precise ion energy control, ensuring high sensitivity and effective interference removal in helium mode. The torch auto-aligns with the interface following maintenance.

## 27 MHz Plasma RF Generator

The fast, frequency-matching RF generator supports the most robust plasma conditions (lowest CeO/Ce ratio) for maximum tolerance of high and variable matrix levels.

## Interface Cones

Standard Ni, or optional Pt-tipped cones increase ion transmission and matrix tolerance. Screw-threaded for easy removal during maintenance.

## Off-Axis Ion Lens

Dual, conical Extraction lens and off-axis Omega lens deliver high ion transmission and minimal mass bias, without requiring mass-specific voltage optimization.

## Compact Benchtop Design

The world's smallest ICP-MS system saves valuable bench space while ensuring easy access for servicing and maintenance.

## Agilent Parts and Supplies

Manufactured to stringent specifications to ensure top quality, and rigorously tested to maximize instrument performance.



## World's Most Powerful ICP-MS Software

With automated system optimization, intelligent method setup, remote monitoring capability, and a simplified user interface, Agilent ICP-MS MassHunter software blends powerful features with unprecedented ease of use.

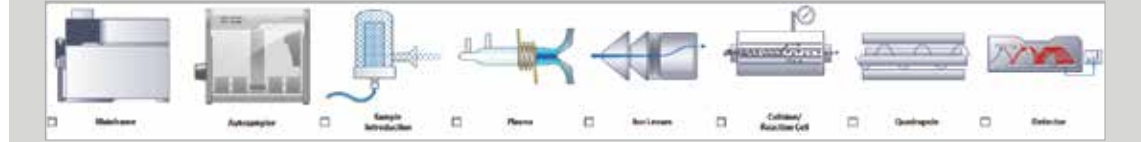

## Orthogonal Detector System (ODS)

The ODS delivers higher sensitivity, lower background, and a wider measurement range – up to 11 orders of magnitude from 0.1 cps to 10 Gcps – virtually eliminating over-range results.



## Hyperbolic Quadrupole Mass Filter

High frequency, 3 MHz, true hyperbolic profile quadrupole delivers high ion transmission with superior peak separation and abundance sensitivity. Eliminates the need for custom quadrupole settings to separate adjacent peaks.

## 4th-Generation Octopole Reaction System (ORS<sup>4</sup>)

Temperature-controlled collision/reaction cell with a new gas controller for fast cell gas switching in less than 3 seconds.

### Octopole Ion Guide

The octopole provides high ion transmission and superior interference removal by KED in helium collision mode, and has been field-proven in thousands of Agilent ICP-MS installations.



## Vacuum System

A single, high-performance split-flow turbo pump and external rotary pump optimize vacuum in the interface region, increasing sensitivity while improving matrix tolerance.

The Value Of Knowing  
[www.agilent.com/chem/atomic](http://www.agilent.com/chem/atomic)



Agilent AA



Agilent MP-AES



Agilent ICP-OES



Agilent ICP-MS



Agilent ICP-QQQ